

MCKINLEY

K-8

# *McKinley School*



MASTER PLAN UPDATE  
29 SEPTEMBER 2009

**LPA**

# *campus master plan* EXISTING SITE PLAN

MCKINLEY

K-8

DEL MAR BLVD

OAK KNOLL AVE





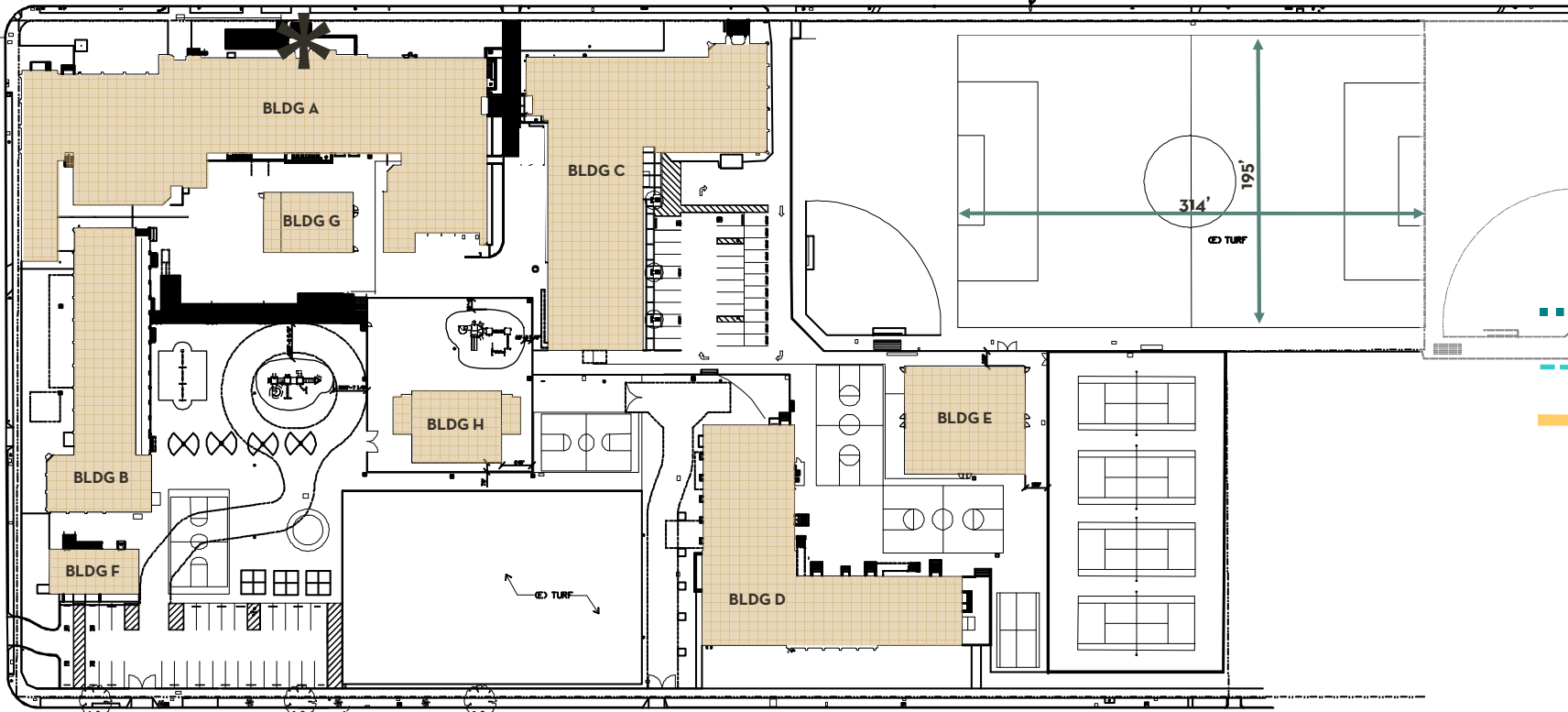







(FIRE DEPT. ACCESS FROM STREET)

(FIRE HYDRANT)



EL MOLINO AVE

(FIRE HYDRANT)

-  EXISTING BUILDINGS
-  NEW BUILDINGS
-  MAIN QUAD
-  KINDERGARTEN COMMONS
-  HARDCOURTS
-  PARKING
-  COVERED LUNCH AREA
-  MAIN ENTRANCE
-  SECONDARY ENTRANCE
-  MAIN PEDESTRIAN CIRCULATION
-  SECONDARY PEDESTRIAN CIRCULATION
-  VEHICULAR CIRCULATION

# *campus master plan*

## PROPOSED MASTER PLAN

MCKINLEY

K-8

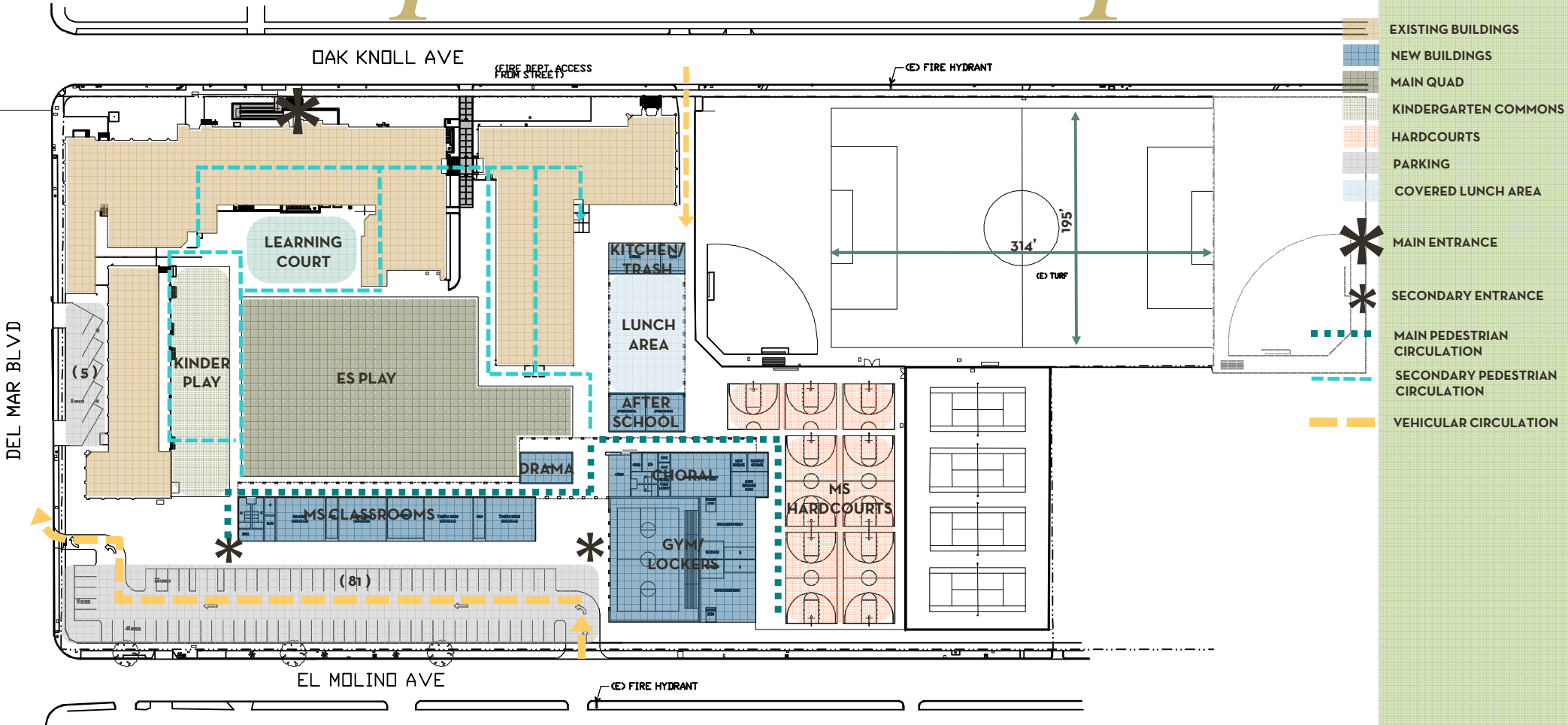

# campus master plan

## PROPOSED FLOOR PLAN - BLDG A

MCKINLEY

K-8

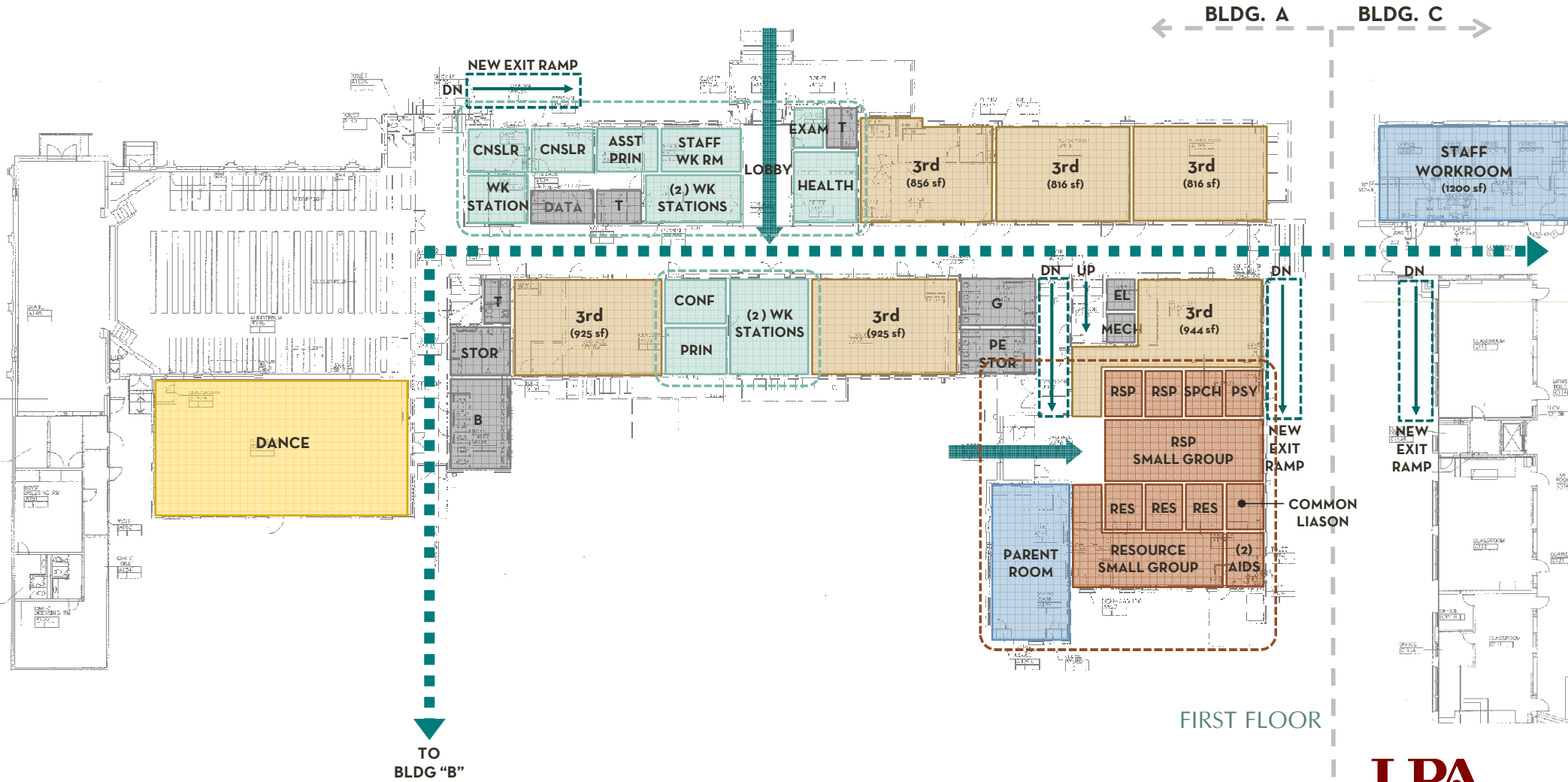

# *campus master plan*

## PROPOSED FLOOR PLAN - BLDG A

MCKINLEY

K-8



SECOND FLOOR

# *campus master plan*

## PROPOSED FLOOR PLAN - BLDG B

MCKINLEY

K-8

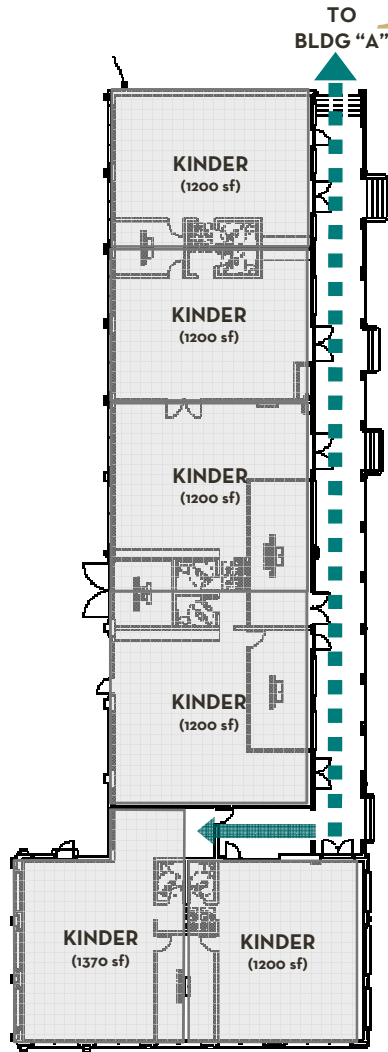

FIRST FLOOR



# campus master plan

## PROPOSED FLOOR PLAN - BLDG C

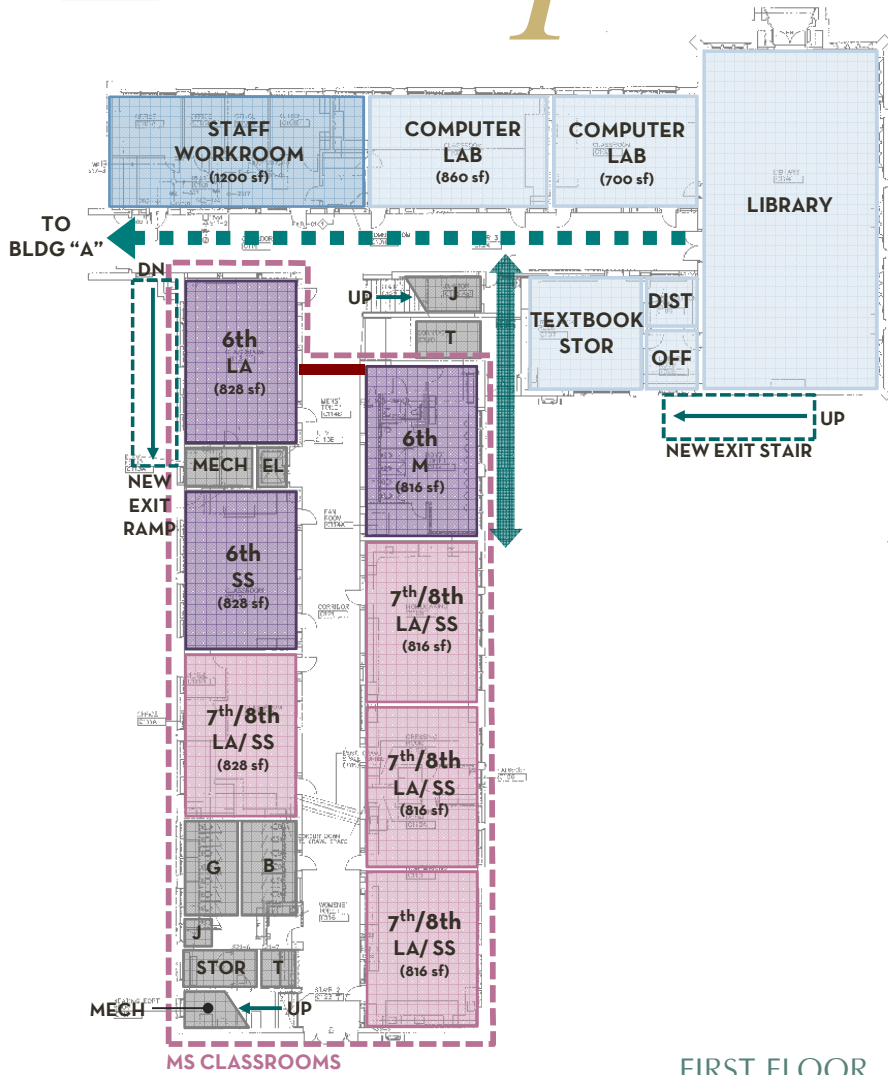

FIRST FLOOR

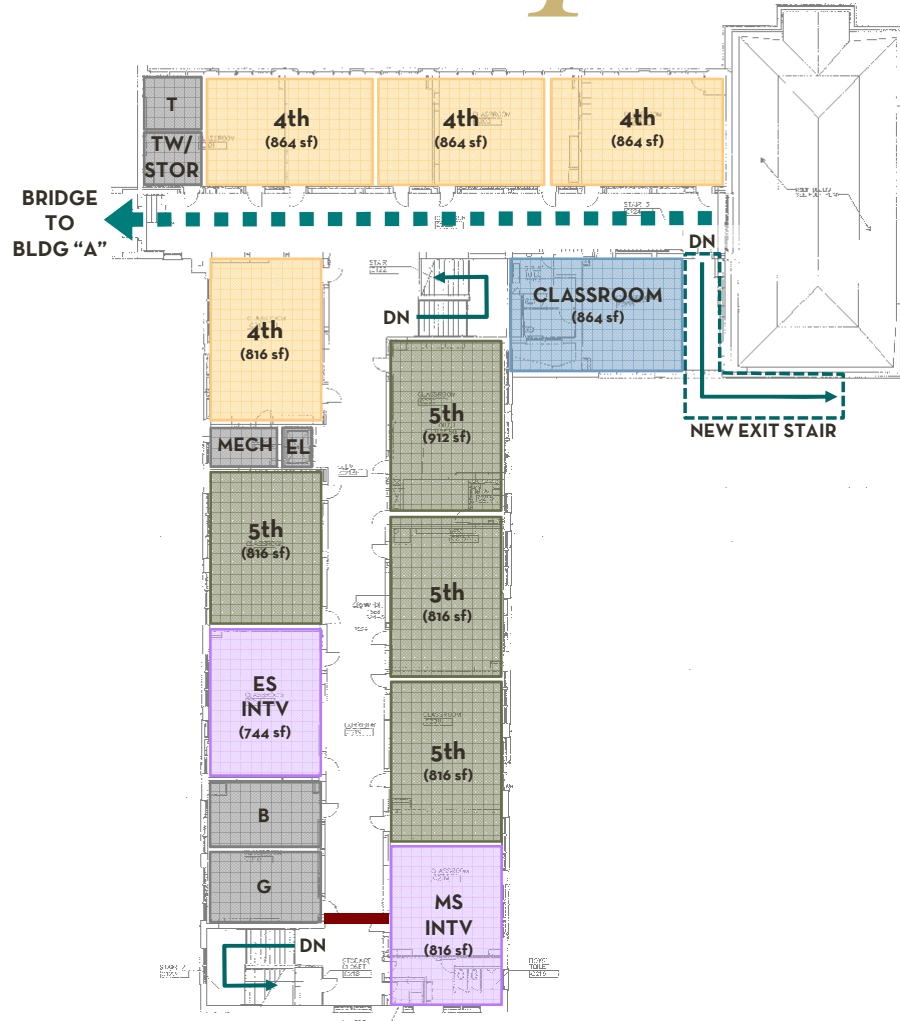

SECOND FLOOR

# gymnasium

## NEW CONSTRUCTION

MCKINLEY

K-8

### PROPOSED NEW CONSTRUCTION Educational Program

#### Space Allocation Detail

Department:	Space:	Type:	Area:	Number:	Total Area:	Square Footage	
						SC/NS	ANC/SP
						Scheduled	Ancillary
						Non-Scheduled	Support

### Replacement Gymnasium

#### Physical Education

Item	Description	Type	Area	Number	Total Area	Notes	
1	Gymnasium	NS	7,665	1	7,665	(105'x73')	
2	Lobby	ANC	600	1	600		
3	Concessions	ANC	100	1	100		
4	Public Toilets	ANC	250	2	500		
5	Janitor Closet	ANC	50	1	50		
6	Boys/Girls Locker Room	ANC	1,950	2	3,900	(w/ Toilet & Showers)	
7	PE Office	ANC	175	2	350		
8	PE Toilet/Changing Room	ANC	100	2	200		
9	Indoor/Outdoor PE Storage	ANC	200	2	400		
10	Mechanical/Electrical Rooms	ANC	100	2	200		
11	Covered Walkway	ANC	600	1	600		
						7,665	6,900
						14,565	

#### Academic/Support Programs

Item	Description	Type	Area	Number	Total Area	Notes	
12	Band/Choral Music Room	SC	1,550	1	1,550		
13	Instrument Storage	ANC	200	1	200		
14	Practice Rooms	ANC	75	2	150		
15	Music Keyboard Room	ANC	600	1	600		
16	Music Library & Office	ANC	200	1	200		
17	Drama Classroom	SC	900	1	900		
18	After School Room	SC	900	2	1,800		
						4,250	1,150
						5,400	

Sub-Totals:  
Construction Total SF:

11,915	8,050
19,965	



# academic

## NEW CONSTRUCTION

MCKINLEY

K-8

### PROPOSED NEW CONSTRUCTION Educational Program

#### Space Allocation Detail

Department:	Space:	Type:	Area:	Number:	Total Area:	Square Footage	
						SC/NS	ANC/SP
						Scheduled Non-Scheduled	Ancillary Support

#### Middle School Program

##### Academic/Support Programs

19	6th Grade Science Lab	SC	1,400	1	1,400	(35'x40')	
20	7th/8th Grade Math/Science Lab	SC	1,400	3	4,200	(35'x40')	
21	Prep Room	ANC	250	2	500		
22	SDC Autism Classroom	SC	960	1	960	(35'x28')	
23	Covered Walkway	ANC	1,500	1	1,500	(8' Wide Walkway)	
						6,560	2,000
						8,560	

#### Food Service Program

##### K-8 Student Dining

24	Serving Kitchen	SP	600	1	600		
25	Dry Storage	SP	150	1	150		
26	Toilet/Changing Room	SP	150	1	150		
27	Janitor Closet	SP	50	1	50		
28	Student Toilets	SP	250	2	500		
29	Mechanical/Electrical Rooms	SP	100	2	200		
30	Lunch Shelter	SP	6,000	1	6,000		
						0	7,650
						7,650	

Sub-Totals:  
Construction Total SF:

0	7,650
7,650	

# *campus master plan*

## PROPOSED MASTER PLAN

MCKINLEY

K-8

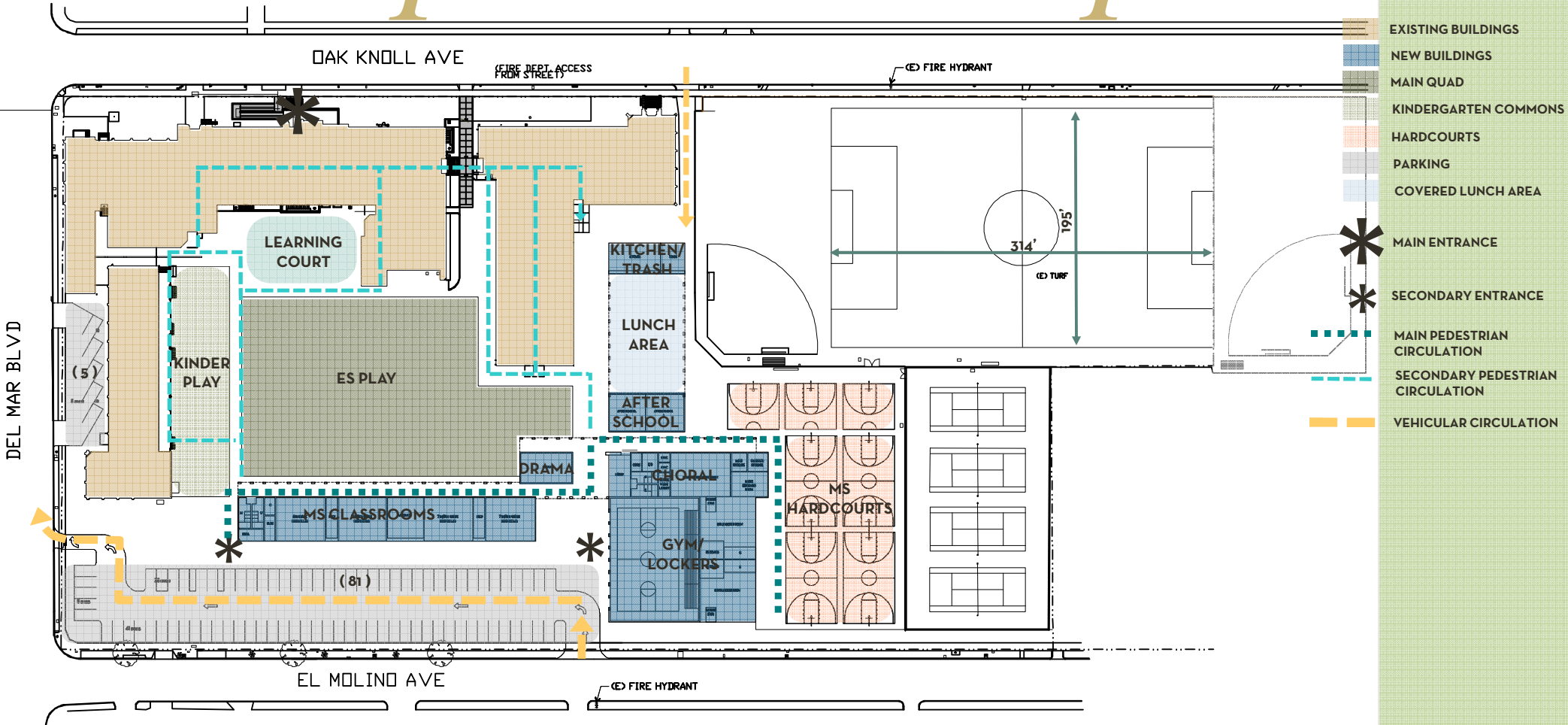

# gymnasium

NEW CONSTRUCTION

MCKINLEY

K-8

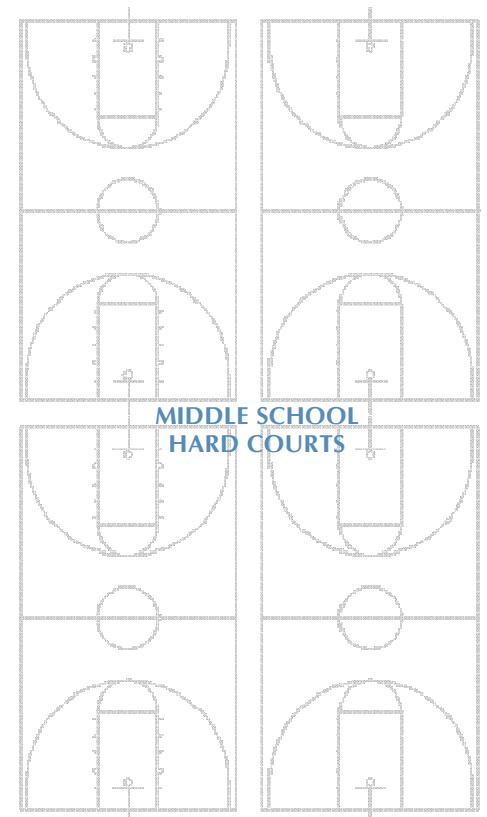
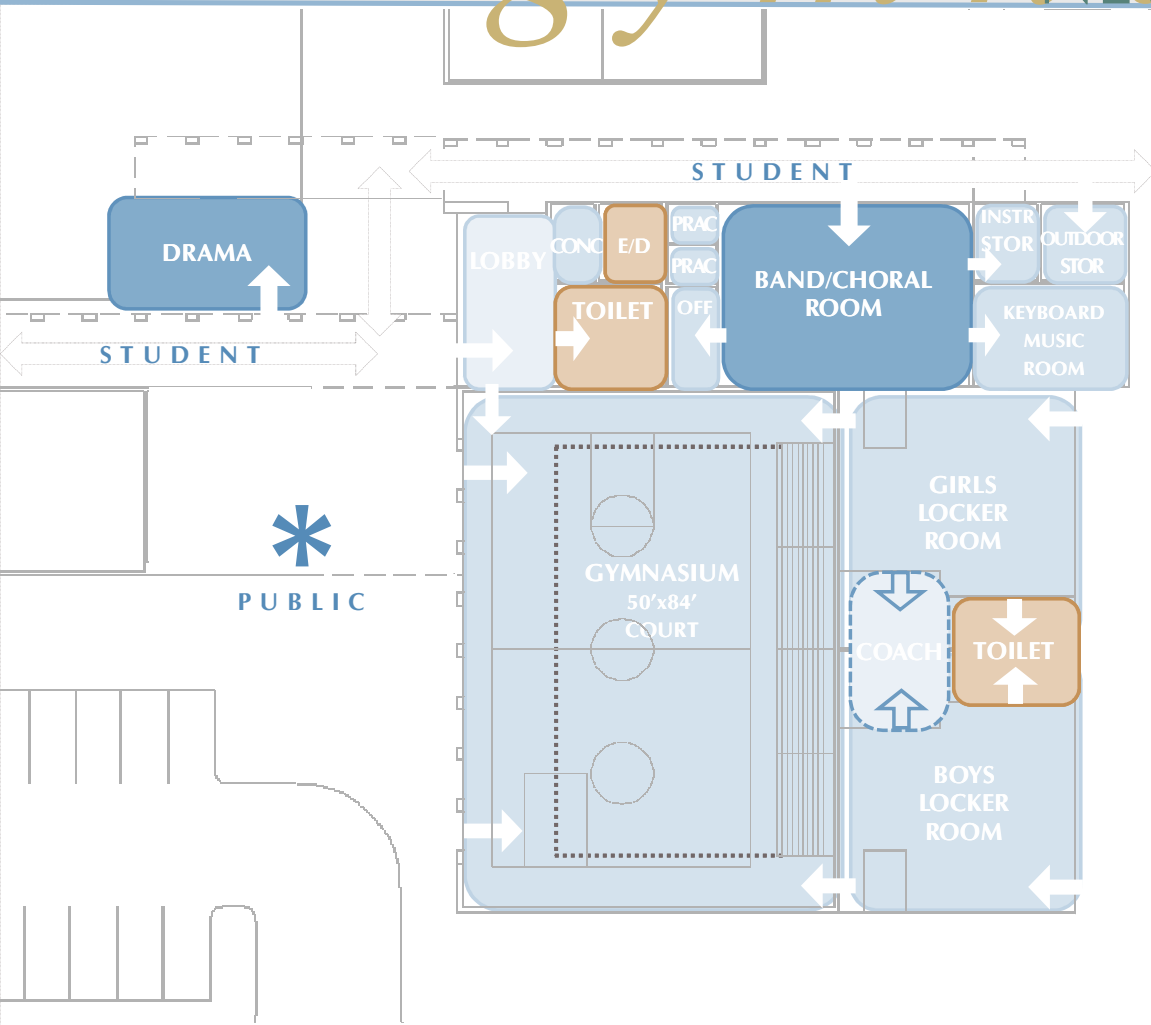

# food service

## NEW CONSTRUCTION

MCKINLEY

K-8

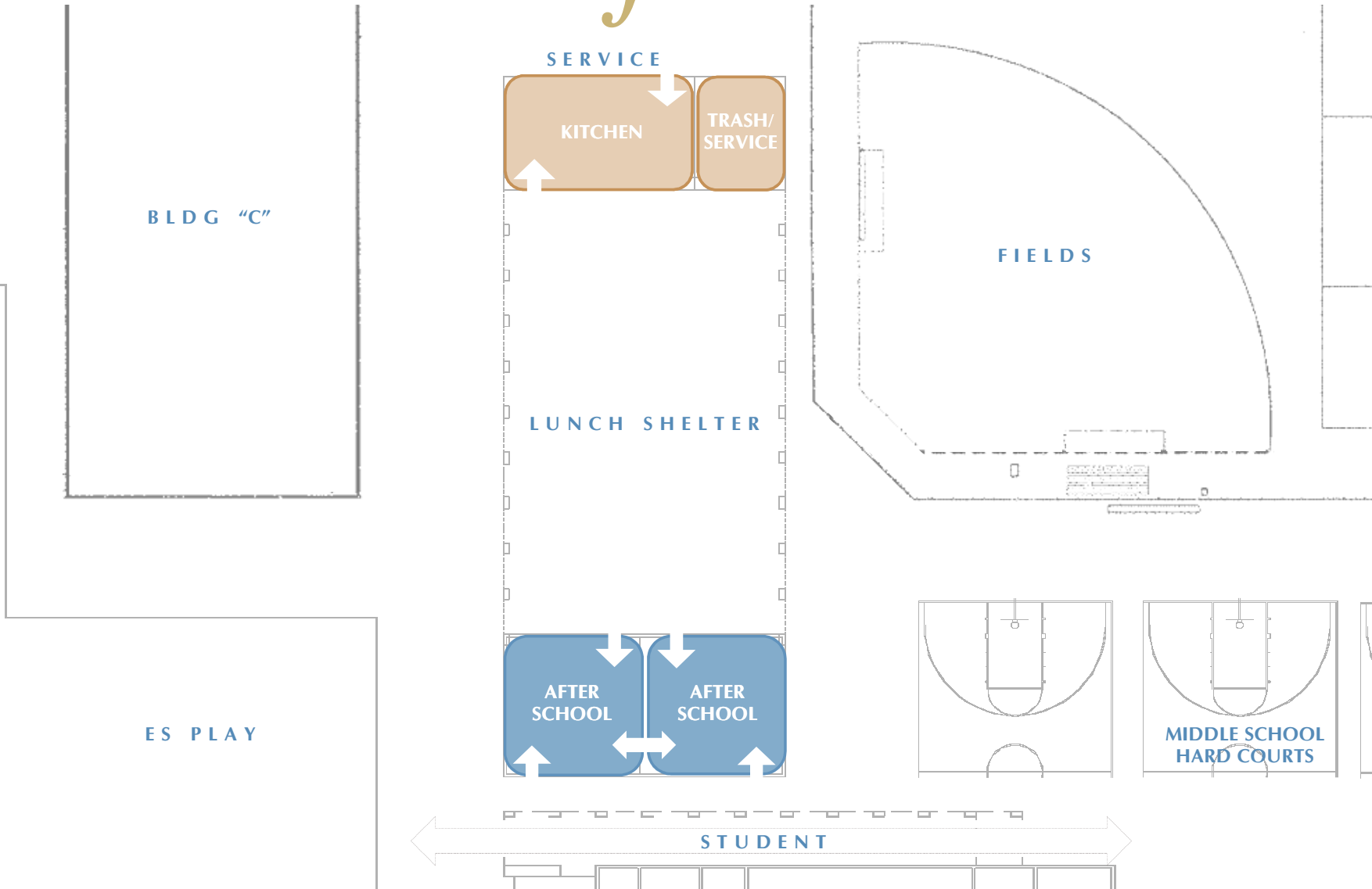

# *a c a d e m i c* NEW CONSTRUCTION

MCKINLEY

K-8

