

McKinley School



Board Presentation
10 November 2009

discussion items AGENDA

MCKINLEY
SCHOOL

- Review Master Plan Priorities
- Review of Existing Buildings and Modernization
- Proposed New Construction Program
- Budget / Cost Estimate Review
- Review Schedule



LPA

master plan priorities LOCAL BOND PROGRAM

MCKINLEY
SCHOOL

- 1. Reconstruct Gym Building**
 - Equity w/ Washington MS
- 2. Modernize Existing A, B, & C Buildings**
 - Includes all Electrical & HVAC Systems
- 3. Modernize Auditorium**
 - Includes Theater Study Scope
- 4. Provide Permanent Lunch Shelter**
 - Demo Existing MPR Portable
- 5. Site Upgrades**
 - ADA Access & Replace Utilities
- 6. Remove Portable Classrooms**
 - Build New MS Building
- 7. Provide On-Site Parking Area**



campus master plan

EXISTING SITE PLAN

MCKINLEY
SCHOOL

DEL MAR BLVD

OAK KNOLL AVE

(FIRE DEPT. ACCESS FROM STREET)

(E) FIRE HYDRANT

BLDG A

BLDG C

BLDG G

314'

195'

(E) TURF

BLDG H

BLDG E

BLDG B

BLDG F

BLDG D

EL MOLINO AVE

(E) FIRE HYDRANT

- EXISTING BUILDINGS
- NEW BUILDINGS
- MAIN QUAD
- KINDERGARTEN COMMONS
- HARDCOURTS
- PARKING
- COVERED LUNCH AREA
- MAIN ENTRANCE
- SECONDARY ENTRANCE
- MAIN PEDESTRIAN CIRCULATION
- SECONDARY PEDESTRIAN CIRCULATION
- VEHICULAR CIRCULATION

campus master plan

PROPOSED MASTER PLAN

MCKINLEY
SCHOOL

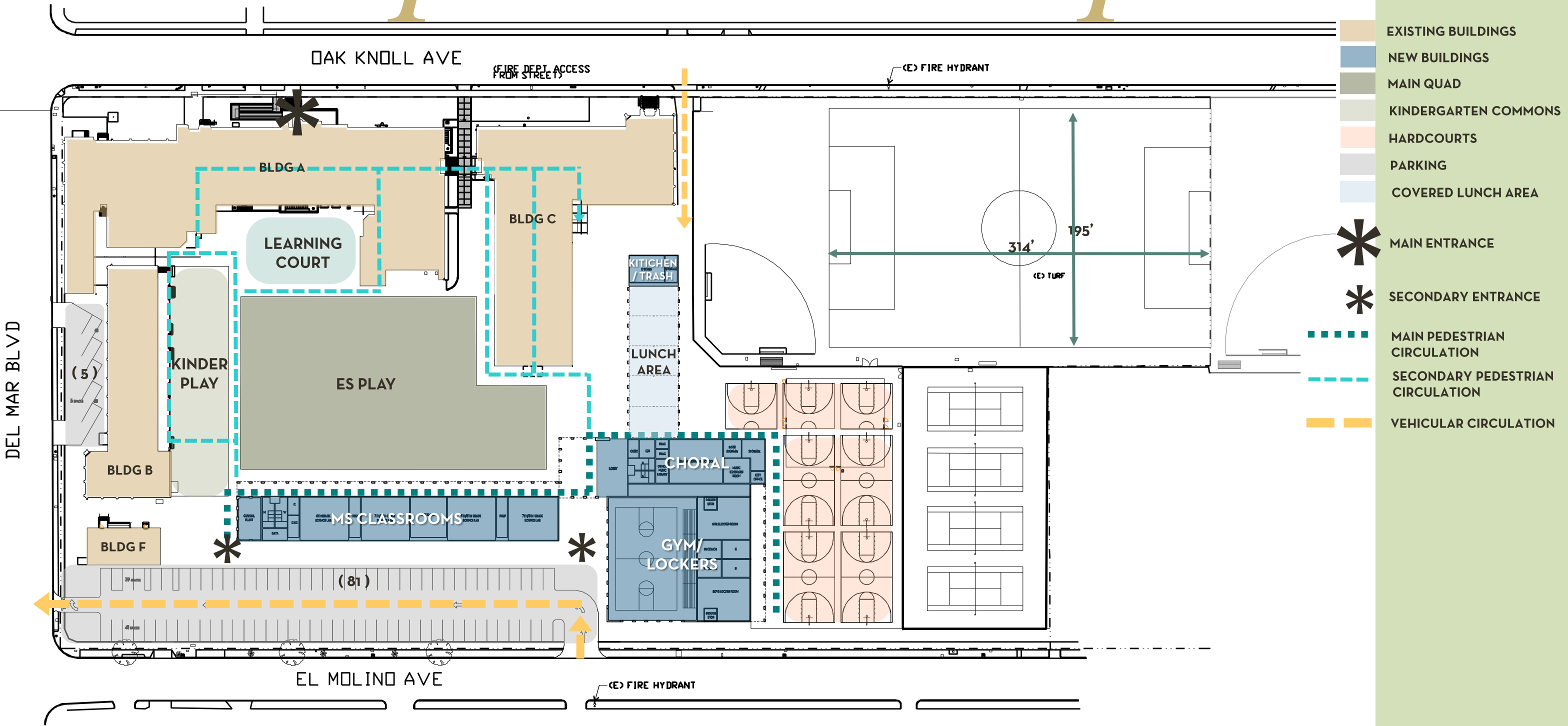

campus master plan

PROPOSED MASTER PLAN

MCKINLEY
SCHOOL

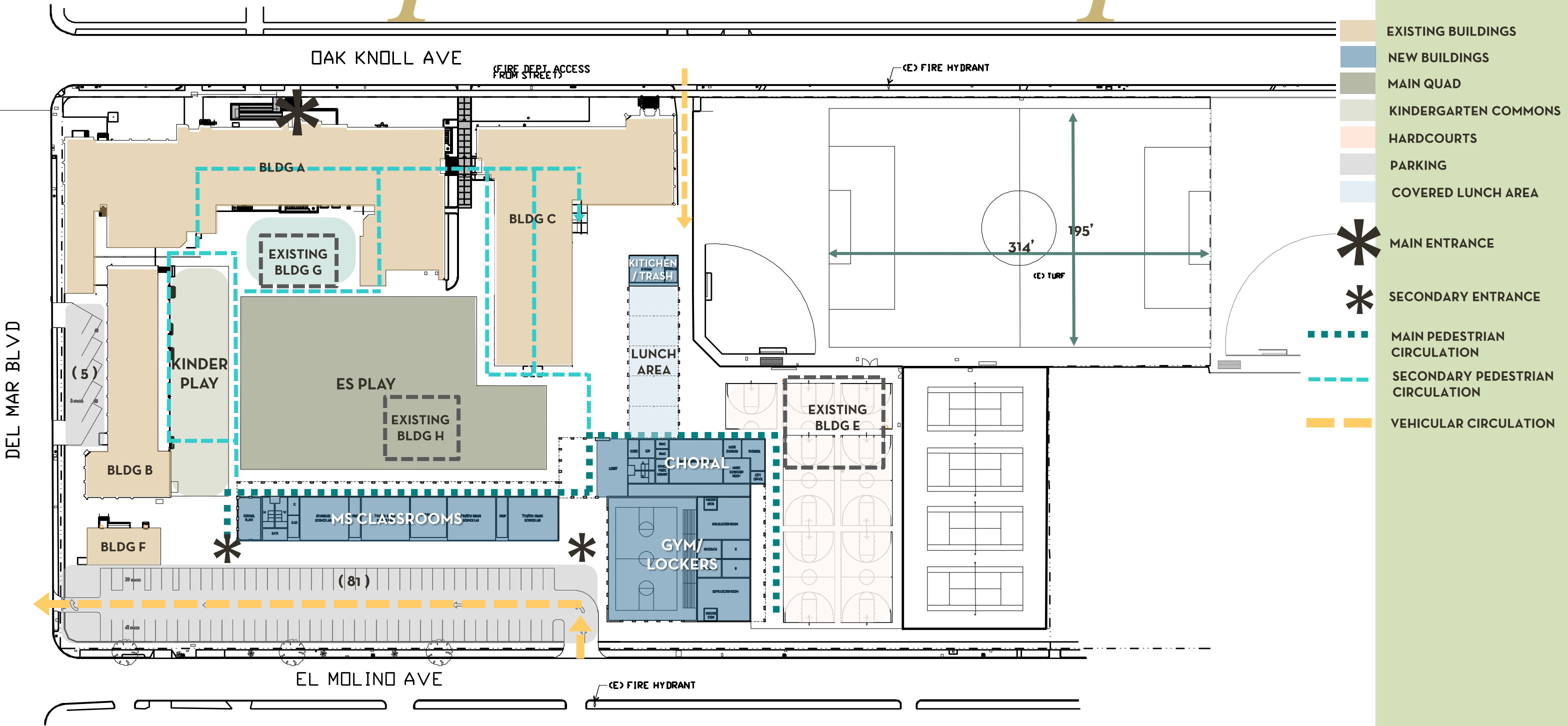

- EXISTING BUILDINGS
- NEW BUILDINGS
- MAIN QUAD
- KINDERGARTEN COMMONS
- HARDCOURTS
- PARKING
- COVERED LUNCH AREA
- * MAIN ENTRANCE
- * SECONDARY ENTRANCE
- MAIN PEDESTRIAN CIRCULATION
- SECONDARY PEDESTRIAN CIRCULATION
- VEHICULAR CIRCULATION

campus master plan

PROPOSED FLOOR PLAN - BLDG A

MCKINLEY
SCHOOL

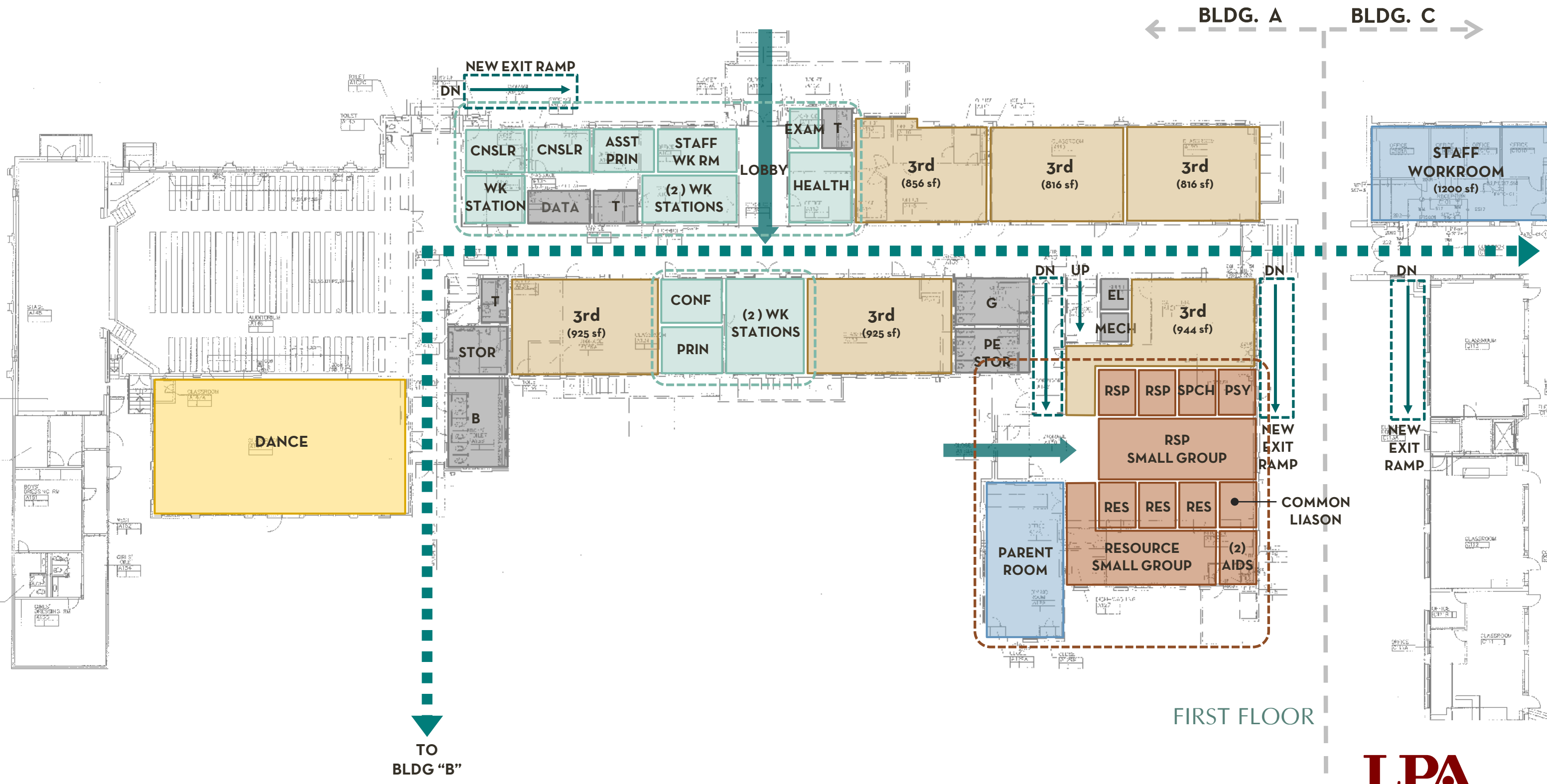

campus master plan

PROPOSED FLOOR PLAN - BLDG A



SECOND FLOOR

campus master plan

PROPOSED FLOOR PLAN - BLDG B

MCKINLEY
SCHOOL

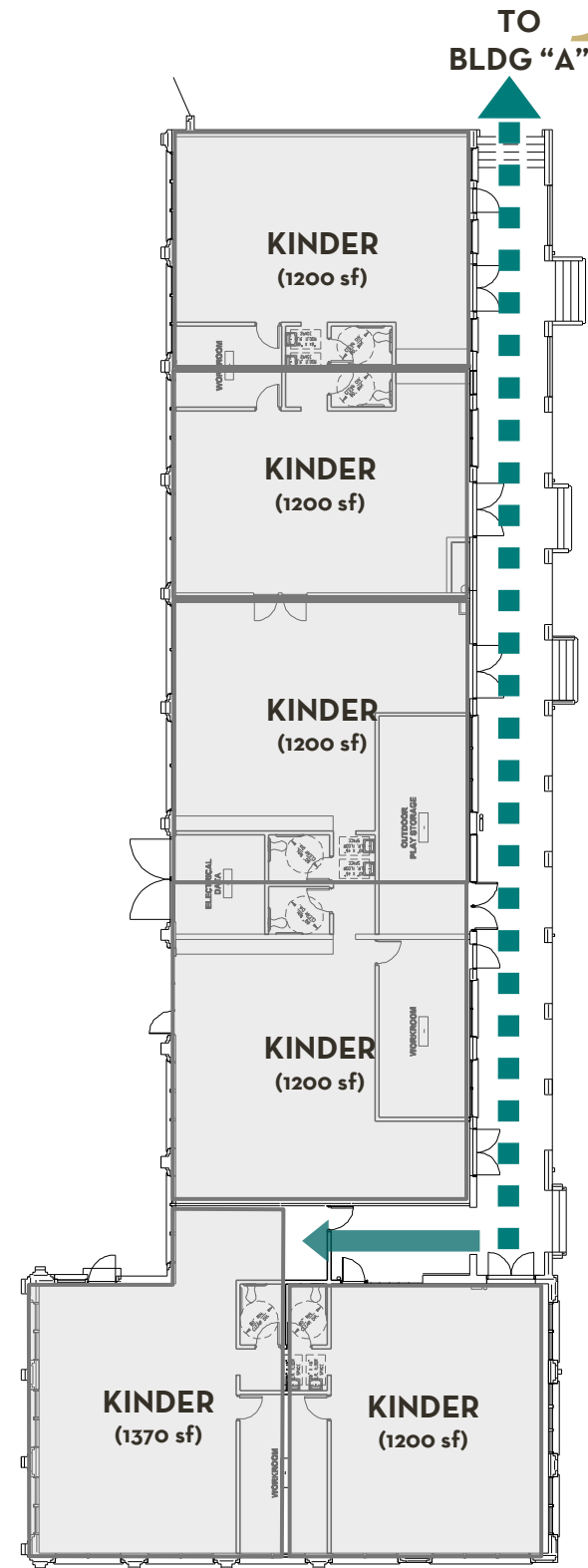

FIRST FLOOR



campus master plan

PROPOSED FLOOR PLAN - BLDG C

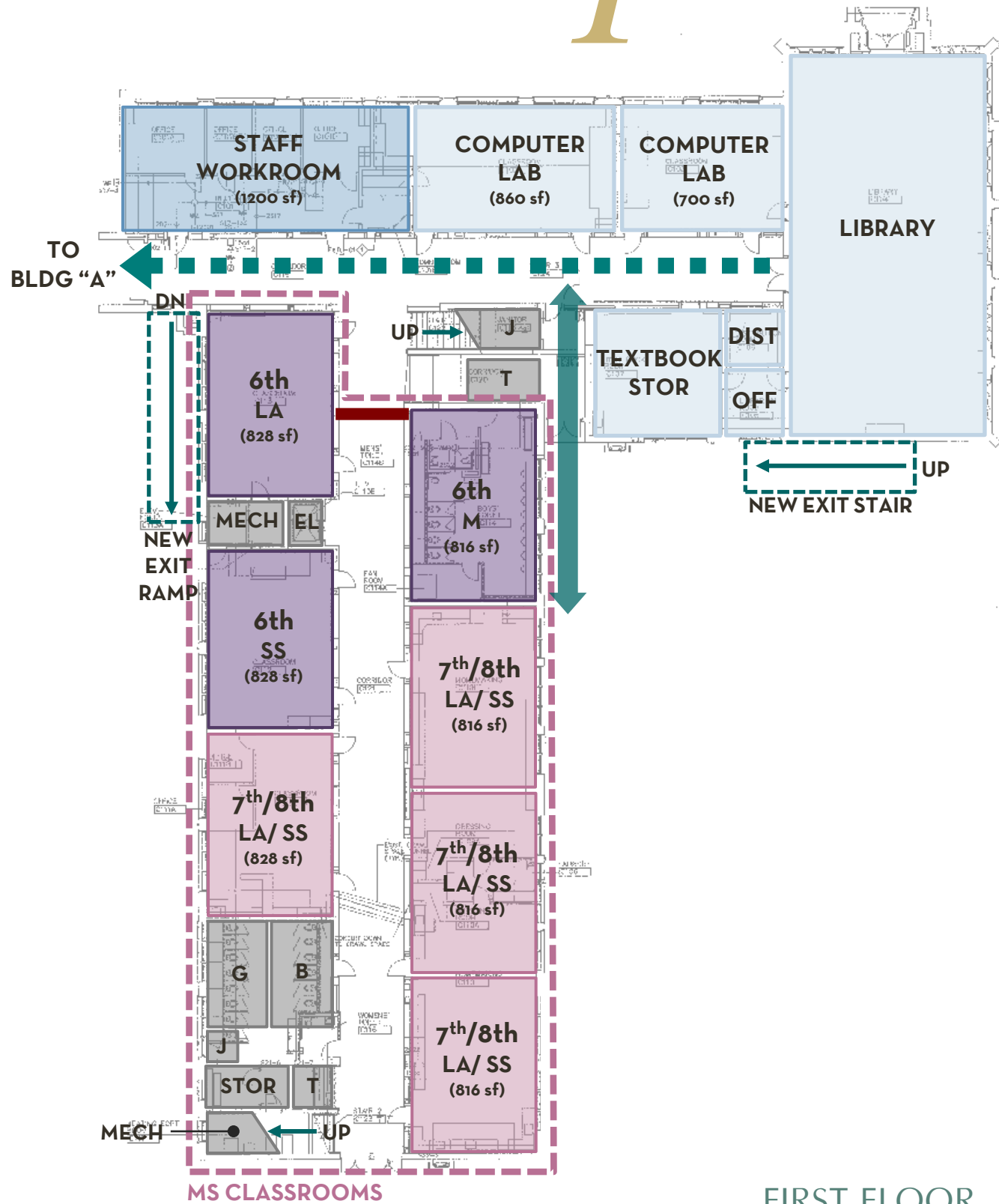

FIRST FLOOR

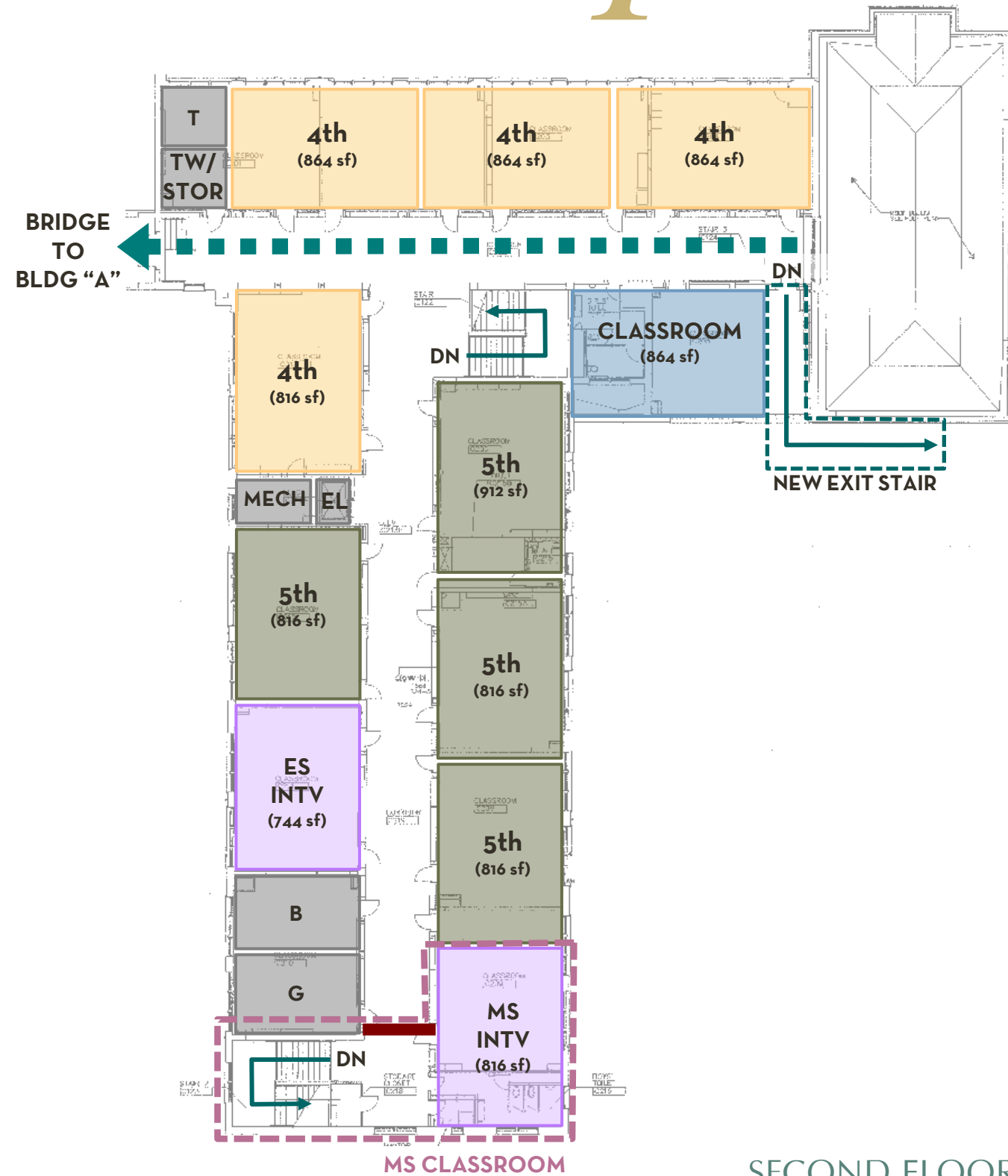

SECOND FLOOR

campus master plan

PROPOSED MASTER PLAN

MCKINLEY
SCHOOL

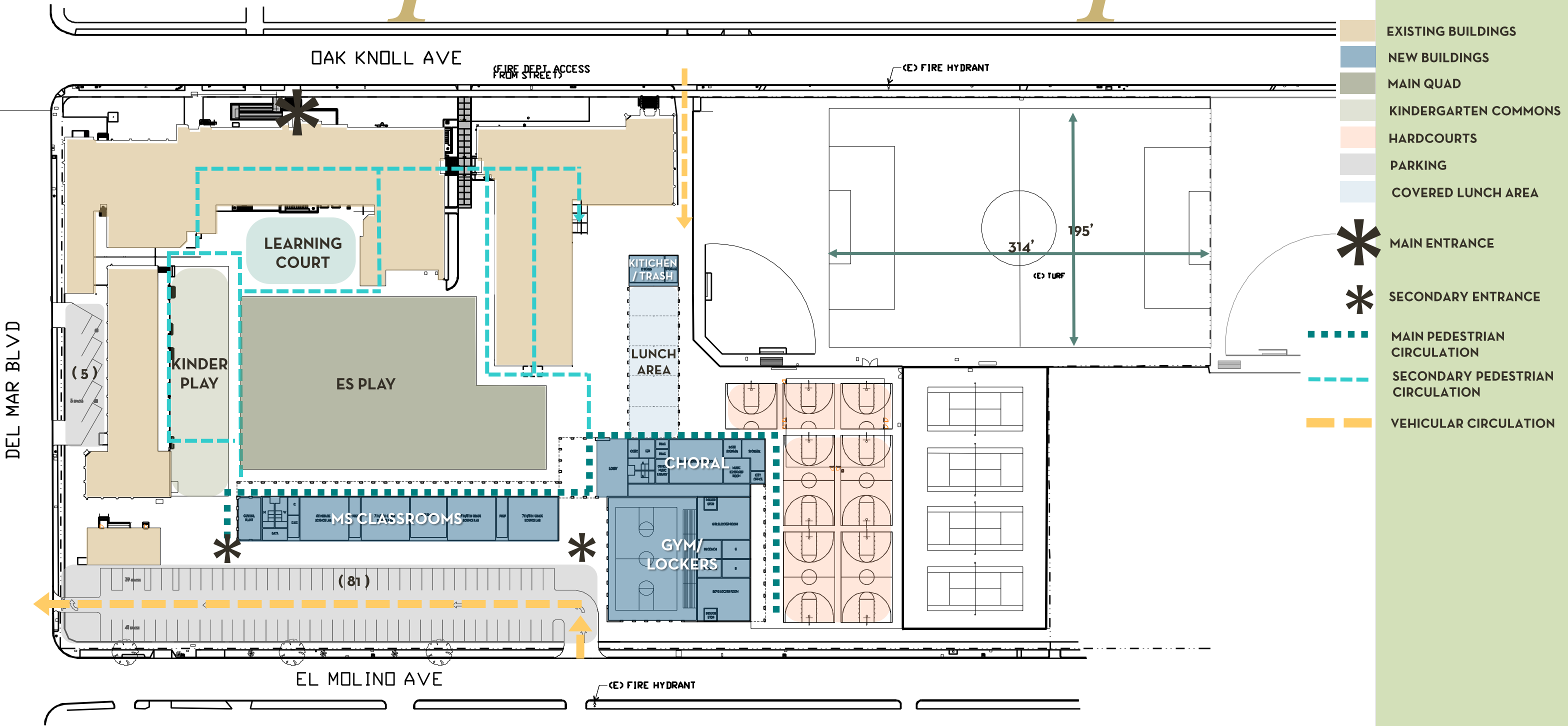

- EXISTING BUILDINGS
- NEW BUILDINGS
- MAIN QUAD
- KINDERGARTEN COMMONS
- HARDCOURTS
- PARKING
- COVERED LUNCH AREA
- MAIN ENTRANCE
- SECONDARY ENTRANCE
- MAIN PEDESTRIAN CIRCULATION
- SECONDARY PEDESTRIAN CIRCULATION
- VEHICULAR CIRCULATION

gymnasium NEW CONSTRUCTION

PROPOSED NEW CONSTRUCTION Educational Program

Space Allocation Detail

Department:	Space:	Type:	Area:	Number:	Total Area:	Square Footage	
						SC/NS	ANC/SP
						Scheduled Non-Scheduled	Ancillary Support

Replacement Gymnasium

Physical Education

1	Gymnasium	NS	7,665	1	7,665	(105'x73')	
2	Lobby	ANC	600	1	600		
3	Concessions	ANC	100	1	100		
4	Public Toilets	ANC	250	2	500		
5	Janitor Closet	ANC	50	1	50		
6	Boys/Girls Locker Room (Changing)	ANC	1,200	2	2,400	(200 Boys/200 Girls)	
7	Boys/Girls Locker Room (Toilet)	ANC	250	2	500		
8	Boys/Girls Locker Room (Shower)	ANC	150	2	300		
9	PE Office	ANC	175	2	350		
10	PE Toilet/Changing Room	ANC	125	2	250		
11	Indoor/Outdoor PE Storage	ANC	200	2	400		
12	Mechanical/Electrical Rooms	ANC	100	2	200		
13	Covered Walkway	ANC	600	1	600		
						7,665	6,250
						13,915	

Academic/Support Programs

14	Band/Choral Music Room	SC	1,600	1	1,600		
15	Instrument Storage	ANC	200	1	200		
16	Practice Rooms	ANC	75	2	150		
17	Music Keyboard Room	ANC	600	1	600		
18	Music Library & Office	ANC	200	1	200		
						1,600	1,150
						2,750	

Sub-Totals:

9,265	7,400
-------	-------

Construction Total:

16,665

gymnasium

NEW CONSTRUCTION

MCKINLEY
SCHOOL

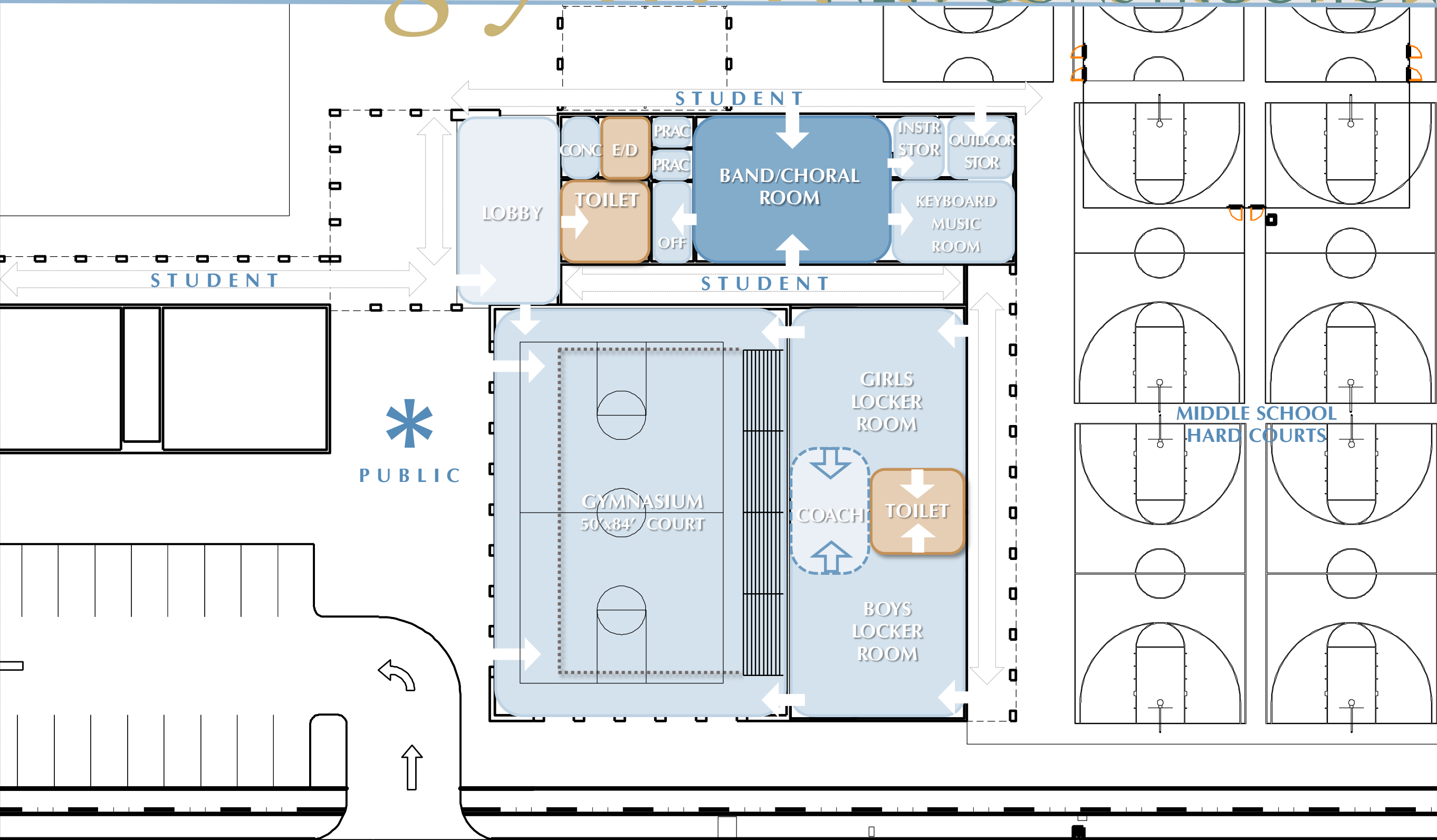

PROPOSED NEW CONSTRUCTION Educational Program

Space Allocation Detail

Department:	Space:	Type:	Area:	Number:	Total Area:	Square Footage	
						SC/NS	ANC/SP
						Scheduled Non-Scheduled	Ancillary Support

Middle School Program

Academic/Support Programs

19	6th Grade Science Lab	SC	1,400	1	1,400	(35'x40')	
20	7th/8th Grade Math/Science Lab	SC	1,400	3	4,200	(35'x40')	
21	Prep Room	ANC	250	2	500		
22	SDC Autism Classroom	SC	960	1	960	(35'x28')	
23	Covered Walkway	ANC	1,500	1	1,500	(8' Wide Walkway)	
						6,560	2,000
						8,560	

Food Service Program

K-8 Student Dining

24	Serving Kitchen	SP	600	1	600		
25	Dry Storage	SP	150	1	150		
26	Toilet/Changing Room	SP	150	1	150		
27	Janitor Closet	SP	50	1	50		
28	Student Toilets	SP	250	2	500		
29	Mechanical/Electrical Rooms	SP	100	2	200		
30	Lunch Shelter	SP	6,000	1	6,000		
						0	7,650
						7,650	

Sub-Totals:
Construction Total SF:

0	7,650
7,650	

a c a d e m i c NEW CONSTRUCTION

MCKINLEY
SCHOOL

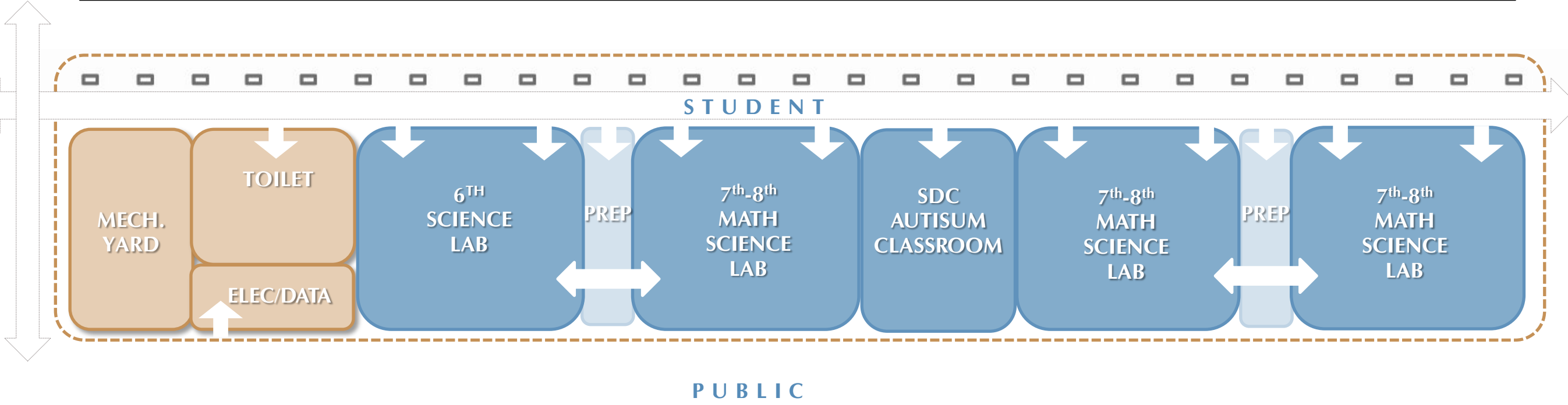

food service

NEW CONSTRUCTION

MCKINLEY
SCHOOL

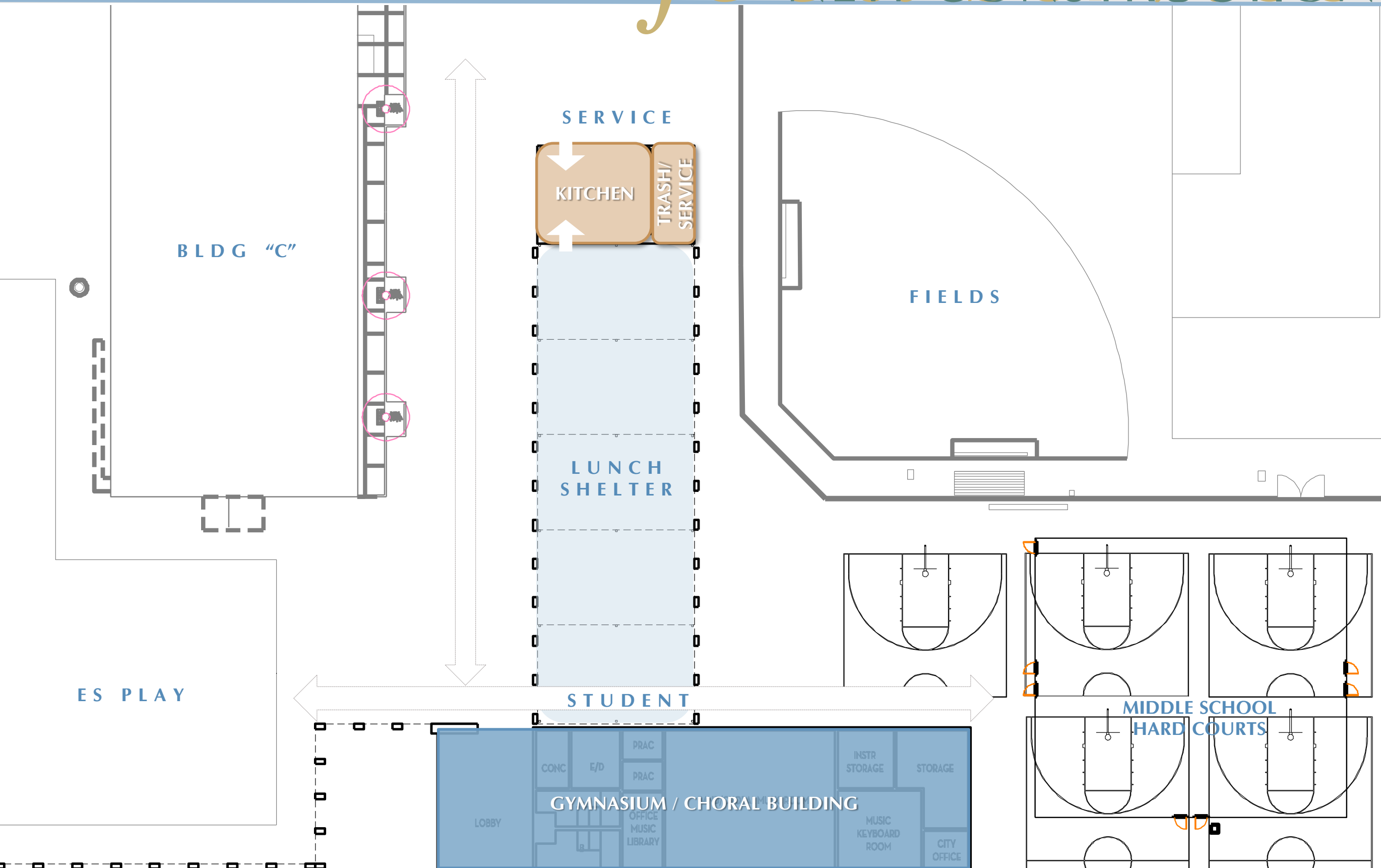

master plan budget

LOCAL BOND PROGRAM

MCKINLEY
SCHOOL

■ Total Construction Budget	\$31,636,630*
■ Current Cost Estimate	- \$32,348,000
	<hr/>
■ Budget Deficiency	- \$ 711,370

***Note:** Budget will adjust with addition of deferred maintenance funding and subtraction of costs for district central kitchen and other district wide scopes.

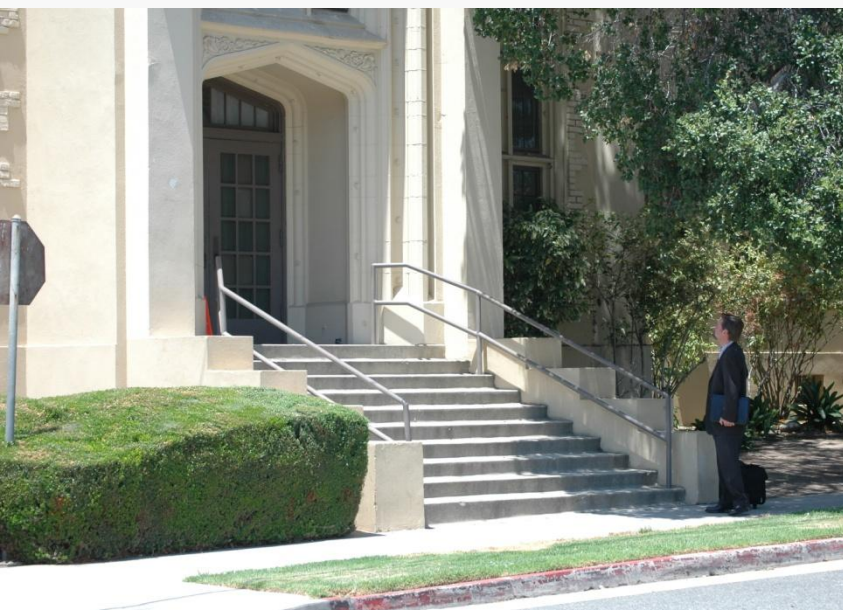

campus master plan

PHASE 1 SITE PLAN

MCKINLEY
SCHOOL

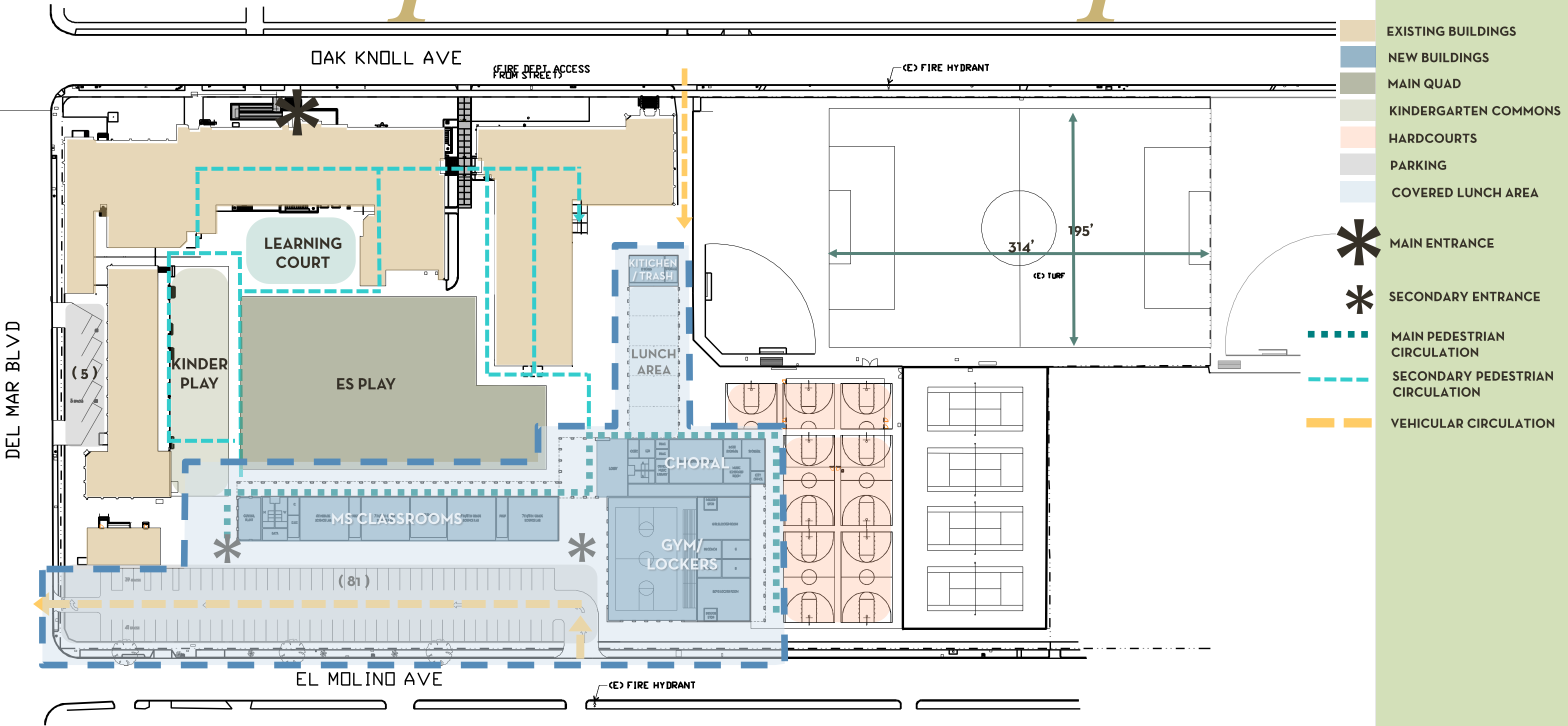

- EXISTING BUILDINGS
- NEW BUILDINGS
- MAIN QUAD
- KINDERGARTEN COMMONS
- HARDCOURTS
- PARKING
- COVERED LUNCH AREA
- ✱ MAIN ENTRANCE
- ✱ SECONDARY ENTRANCE
- MAIN PEDESTRIAN CIRCULATION
- SECONDARY PEDESTRIAN CIRCULATION
- VEHICULAR CIRCULATION

PHASE 1 ESTIMATE: \$12,298,000



campus master plan

PHASE 2 SITE PLAN

MCKINLEY
SCHOOL

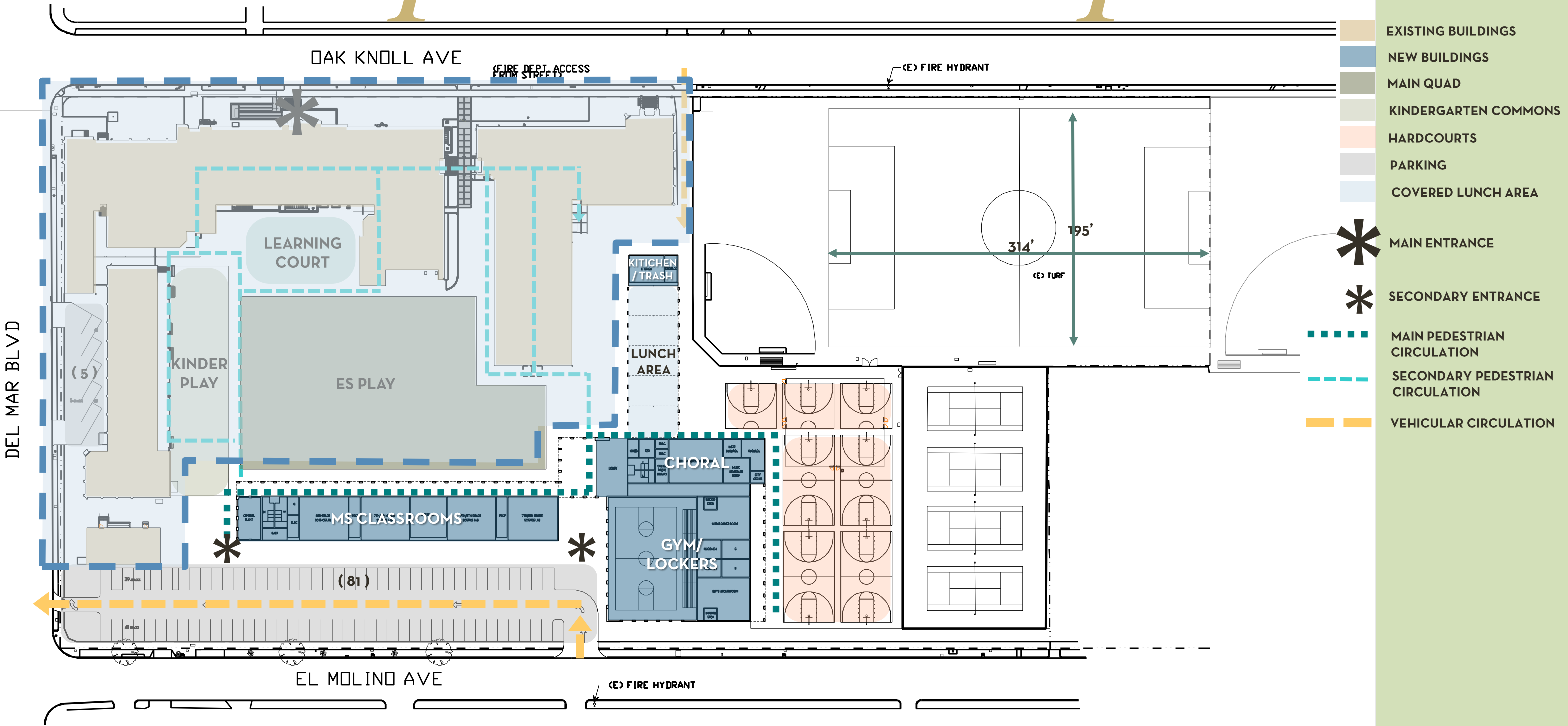

- EXISTING BUILDINGS
- NEW BUILDINGS
- MAIN QUAD
- KINDERGARTEN COMMONS
- HARDCOURTS
- PARKING
- COVERED LUNCH AREA
- MAIN ENTRANCE
- SECONDARY ENTRANCE
- MAIN PEDESTRIAN CIRCULATION
- SECONDARY PEDESTRIAN CIRCULATION
- VEHICULAR CIRCULATION

PHASE 2 ESTIMATE: \$19,400,000



closing

MCKINLEY
SCHOOL

• Thank You.

LPA



'Creating Sustainable Places and Spaces that enrich the lives of those who use them'

master plan **COMPARISON** budget

MCKINLEY
SCHOOL

Priority	Scope	Current Cost Estimate	GKK Master Plan Budget
A	Reconstruction of Gym Building	\$ 6,062,576	\$ 6,524,779
C	Modernize Building A, B & C	\$ 16,970,712	\$ 20,569,811
B	Reconstruction of Kindergarten Classroom Building	included in C	included in C
D	New HVAC Upgrades in Building A, B & C	included in C	included in C
J	Modernize Bathrooms	included in C	included in C
M	Replace Floor Finishes in Main Building (A)	included in C	included in C
N	Replace Acoustic Tile Ceiling in Main Building (A)	included in C	included in C
O	Light Fixture Upgrades at Building A	included in C	included in C
E	Modernize Auditorium / Cafeteria Building	\$ 3,367,092	\$ 1,980,920
F	Permanent Lunch Shelter	\$ 424,564	\$ 136,146
G	Site ADA Upgrades Include New Drinking Fountains	\$ 41,120	\$ 144,654
H	Relace Electrical Panel Board	\$ 245,692	\$ 37,440
I	Ramps & Accessible Paths to Playfields & Main Classroom Bldg	\$ 479,048	\$ 178,691
K	Shade Structures at Playground	-	\$ 272,291
L	Sep Domestic, Fire & Irrigation Meters	\$ 77,100	\$ 91,898
	District Deferred Maintenance		\$ 1,700,000
	Scope not listed in master plan above:		
1	Middle School Building & Augmented Site Work	\$ 4,680,096	
	Estimated Construction Cost	\$ 32,348,000	\$ 31,636,630
	(includes design contingency and escalation)		

